

# TECHNICAL SPECIFICATION

## Connectors

A	January 13, 2025	James	Mr.Gu	Hugo
Version	Date	Prepared	Reviewed	Approved



No.	Description	ZTT code
3.2	1/2"S 4.3-10 Type Male Connector	4310M-9
3.3	1/2"S 7/16(Din) Type Male Connector	DINM-9

# 1/2"S 4.3-10 Type Male Connector (4310M-9)

## 1. Description

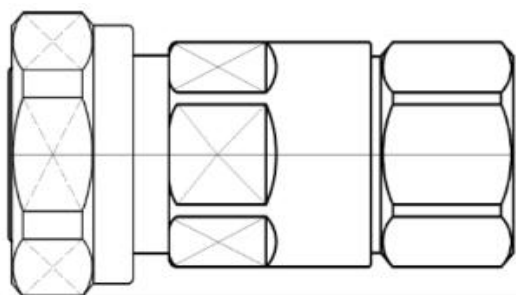

RF connector with 4.3-10 type is typical type for communication systems.

ZTT connectors have the following features:

- (a) Excellent VSWR Performance
- (b) Fast and Easy Installation
- (c) Waterproof
- (d) Environment Resistance Ensures Long Life and Consistent Performance

Note: The picture is for reference only.

## 2. Electrical Characteristics

Item	Specification	
Characteristic impedance ( $\Omega$ )	$50 \pm 2$	
Frequency range (GHz)	0~8	
VSWR	0-2GHz	1.036
	2-2.6GHz	1.065
Contact resistance (m $\Omega$ )	Center contact $\leq 1$ , outer contact $\leq 0.6$	
Dielectric resistance (M $\Omega$ )	$\geq 10000$	
IP3 (dBc)	$\leq -155$	
Sealing level	IP68	

Note: The tolerance of VSWR shall be  $\pm 5\%$ .

## 3. Mechanical Characteristics

Item	Specification
Durability (cycles)	Mating cycles $\geq 500$

## 4. Environmental Characteristics

Item	Specification
Operation temperature ( $^{\circ}\text{C}$ )	-35~+55
Installation temperature ( $^{\circ}\text{C}$ )	-25~+55
Storage temperature ( $^{\circ}\text{C}$ )	-40~+50

# 1/2"S 7/16(Din) Type Male Connector (DM-9)

## 1. Description

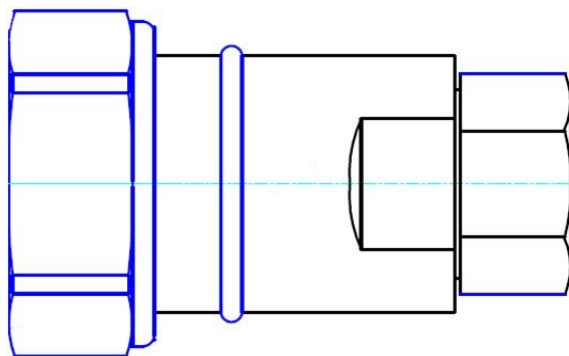

RF connector with 7/16(Din) type is typical type for communication systems.  
 ZTT connectors have the following features:  
 (a) Excellent VSWR Performance  
 (b) Fast and Easy Installation  
 (c) Waterproof  
 (d) Environment Resistance Ensures Long Life and Consistent Performance

Note: The picture is for reference only.

## 2. Electrical Characteristics

Item	Specification	
Characteristic impedance ( $\Omega$ )	$50 \pm 2$	
Frequency range (GHz)	0~8	
VSWR	0-2GHz	1.036
	2-2.6GHz	1.065
Contact resistance ( $m\Omega$ )	Center contact $\leq 1$ , outer contact $\leq 0.6$	
Dielectric resistance ( $M\Omega$ )	$\geq 10000$	
IP3 (dBc)	$\leq -155$	
Sealing level	IP68	

Note: The tolerance of VSWR shall be  $\pm 5\%$ .

## 3. Mechanical Characteristics

Item	Specification
Durability (cycles)	Mating cycles $\geq 500$

## 4. Environmental Characteristics

Item	Specification
Operation temperature ( $^{\circ}\text{C}$ )	$-35 \sim +55$
Installation temperature ( $^{\circ}\text{C}$ )	$-25 \sim +55$
Storage temperature ( $^{\circ}\text{C}$ )	$-40 \sim +50$