

Product Specification

4310F-4310F

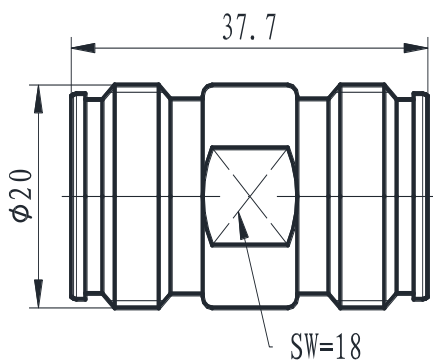

4.3-10 straight female to 4.3-10 straight female adapter

ID:2.4.81.8282.1(01)

AD000031 Rev: A0

*The above picture is only for reference, we may change the appearance design in order to enhance performance without notification.

Material and Plating

Center contact	Tin-bronze/Silver Plated
Outer contact	Tin-bronze/Silver Plated
Body	Brass/Silver Plated
Dielectric	PTFE

Electrical Specifications

Characteristics Impedance	50 Ohm
Frequency Range	DC~6GHz
Insulation Resistance	$\geq 5000\text{M}\Omega$
Dielectric Withstanding Voltage	2000V rms
Operating Voltage	1400V rms
Center contact resistance	$\leq 1.0\text{m}\Omega$
Outer contact resistance	$\leq 0.6\text{ m}\Omega$
Insertion Loss	@DC-3 GHz $\leq 0.17\text{dB}$
VSWR	@DC-3 GHz ≤ 1.10
PIM3(2*43dBm)	@1800MHz $\leq -160\text{dBc}$

Environmental & Mechanical Specifications

Durability (matings)	≥ 500 cycles
Mechanical Shock Test Method	MIL-STD-202, Method 213, Test Condition D
Vibration Test Method	MIL-STD-202, Meth. 204, Cond. A
Temperature Range	-45°C to +85°C
RoHS	Compliant

Regulatory Compliance / Certification

ISO 9001:2015	Compliant
---------------	-----------

The facts and figures contained herein are carefully complied to the best of our knowledge, but they are intended for general informational purposes only.